

## BEAM CLAMPS RANGE

## RANGE SIZE CHARTS

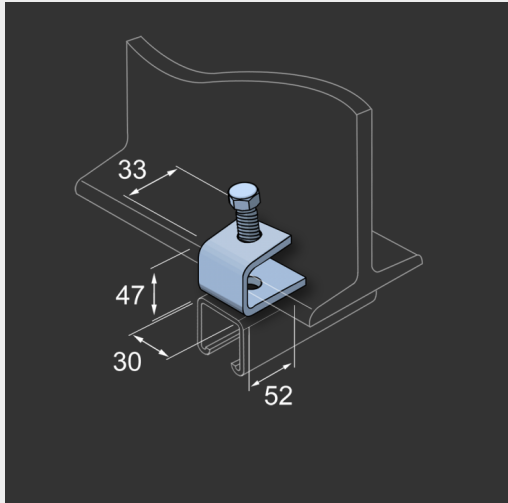

### 145G M10 TAPPED BEAM CLAMP WITH CONE POINT SET SCREW - SIZE CHART

Size	Bag Qty	Pack Qty	Part No. - Ch. Accs.
NA	100		GB37

## ABOUT THE PRODUCT

**Description:** *145g M10 TAPPED BEAM CLAMP* - The Channel Accessory range of bracketry products are manufactured in accordance with BS6946:1988. The brackets are designed and manufactured to primarily support and fix together Channel (Strut) lengths in a metal framework situation. All Channel (Strut) lengths are manufactured in accordance with BS6946:1988.

**Material:** Channel accessories and bracketry are predominantly made from Mild Steel material, in 6mm thick profile. Channel (Strut) lengths are manufactured from Pre Galvanised Steel to BS EN 10346: 2015 and are available in Standard gauge profile (2.5mm thickness) and also Light gauge profile (1.5mm thickness) and have either a Plain or Slotted option. (Slot sizes on Standard gauge are 28 x 14mm. Light gauge are 28 x 11mm).

**Finishes:** Channel Accessories and bracketry products are available with a Hot Dipped Galvanised finish. Channel (Strut) lengths are available in a Pre Galvanised finish. Both finishes are readily available from stock. Other finishes are available to order.

**Connections / Fixing Methods:** The range of Channel accessories and bracketry are predominantly pre drilled with 14mm fixing holes allowing the use of bolts and threaded rod to facilitate fixings.

**Country of Origin:** Channel accessories and bracketry are manufactured in India. Channel (Strut) lengths are manufactured in the UK.

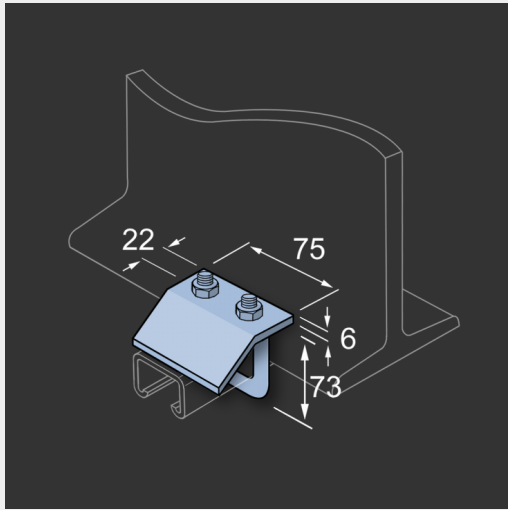

## M10 BEAM CLAMPS WITH SQUARE U BOLT AND NUTS – GALVANISED - SIZE CHART

Size	Bag Qty	Pack Qty	Part No. - Ch. Accs.
41 x 21mm	50		GB1921
41 x 41mm	50		GB1941
41 x 82mm	50		GB1982

## ABOUT THE PRODUCT

**Description:** M10 BEAM CLAMPS with SQUARE U BOLT - GALVANISED BEAM CLAMP with SQUARE U BOLT AND NUTS M10 - The Channel Accessory range of bracketry products are manufactured in accordance with BS6946:1988. The brackets are designed and manufactured to primarily support and fix together Channel (Strut) lengths in a metal framework situation. All Channel (Strut) lengths are manufactured in accordance with BS6946:1988.

**Material:** Channel accessories and bracketry are predominantly made from Mild Steel material, in 6mm thick profile. Channel (Strut) lengths are manufactured from Pre Galvanised Steel to BS EN 10346: 2015 and are available in Standard gauge profile (2.5mm thickness) and also Light gauge profile (1.5mm thickness) and have either a Plain or Slotted option. (Slot sizes on Standard gauge are 28 x 14mm. Light gauge are 28 x 11mm).

**Finishes:** Channel Accessories and bracketry products are available with a Hot Dipped Galvanised finish. Channel (Strut) lengths are available in a Pre Galvanised finish. Both finishes are readily available from stock. Other finishes are available to order.

**Connections / Fixing Methods:** The range of Channel accessories and bracketry are predominantly pre drilled with 14mm fixing holes allowing the use of bolts and threaded rod to facilitate fixings.

**Country of Origin:** Channel accessories and bracketry are manufactured in India. Channel (Strut) lengths are manufactured in the UK.

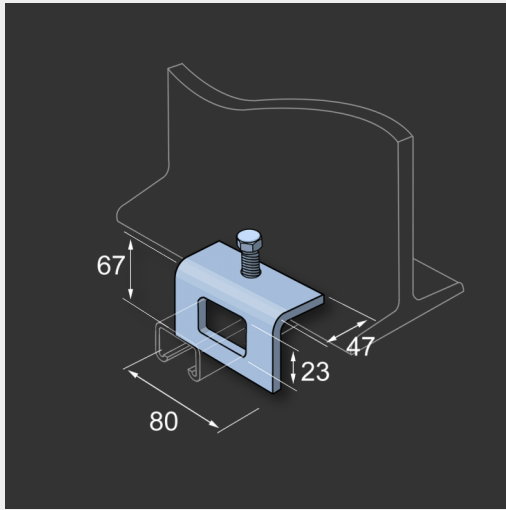

## WINDOW BRACKET WITH CONE POINT SET SCREW – GALVANISED - SIZE CHART

Size	Bag Qty	Pack Qty	Part No. - Ch. Accs.
41 x 21mm	50		GB2021
41 x 41mm	50		GB2041
41 x 82mm	50		GB2082

## ABOUT THE PRODUCT

**Description:** GALVANISED *WINDOW BRACKET with CONE POINT SET SCREW* - The Channel Accessory range of bracketry products are manufactured in accordance with BS6946:1988. The brackets are designed and manufactured to primarily support and fix together Channel (Strut) lengths in a metal framework situation. All Channel (Strut) lengths are manufactured in accordance with BS6946:1988.

**Material:** Channel accessories and bracketry are predominantly made from Mild Steel material, in 6mm thick profile. Channel (Strut) lengths are manufactured from Pre Galvanised Steel to BS EN 10346: 2015 and are available in Standard gauge profile (2.5mm thickness) and also Light gauge profile (1.5mm thickness) and have either a Plain or Slotted option. (Slot sizes on Standard gauge are 28 x 14mm. Light gauge are 28 x 11mm).

**Finishes:** Channel Accessories and bracketry products are available with a Hot Dipped Galvanised finish. Channel (Strut) lengths are available in a Pre Galvanised finish. Both finishes are readily available from stock. Other finishes are available to order.

**Connections / Fixing Methods:** The range of Channel accessories and bracketry are predominantly pre drilled with 14mm fixing holes allowing the use of bolts and threaded rod to facilitate fixings.

**Country of Origin:** Channel accessories and bracketry are manufactured in India. Channel (Strut) lengths are manufactured in the UK.

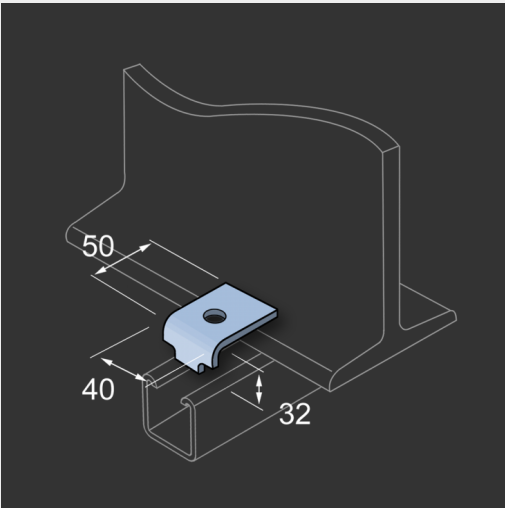

120G BEAM CLAMP – GALVANISED - SIZE CHART			
Size	Bag Qty	Pack Qty	Part No. - Ch. Accs.
NA	200		GB34

### ABOUT THE PRODUCT

**Finishes: 120g BEAMCLAMP - GALVANISED** - Channel Accessories and bracketry products are available with a Hot Dipped Galvanised finish. Channel (Strut) lengths are available in a Pre Galvanised finish. Both finishes are readily available from stock. Other finishes are available to order.

---

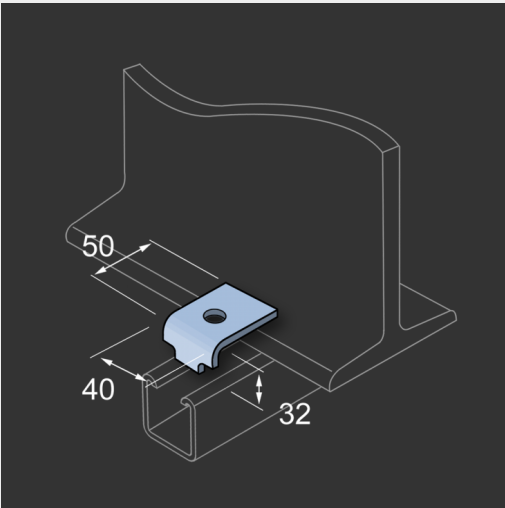

430G M10 TAPPED BEAM CLAMP WITH CONE POINT SET SCREW – GALVANISED - SIZE CHART

Size	Bag Qty	Pack Qty	Part No. - Ch. Accs.
NA	50		GB35

ABOUT THE PRODUCT

Country of Origin: **430g M10 TAPPED BEAM CLAMP** with CONE POINT SET SCREW - GALVANISED - Channel accessories and bracketry are manufactured in India. Channel (Strut) lengths are manufactured in the UK.

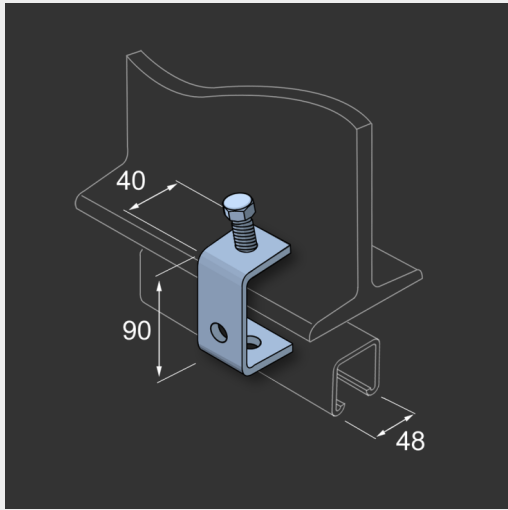

## M10 'C' BEAM CLAMPS TAPPED WITH CONE POINT SET SCREW – GALVANISED - SIZE CHART

Size	Bag Qty	Pack Qty	Part No. - Ch. Accs.
41 x 41mm	25		GB2641

## ABOUT THE PRODUCT

**Description:** GALVANISED 'C' BEAM CLAMPS TAPPED M10 c/w CONE POINT SET SCREW - The Channel Accessory range of bracketry products are manufactured in accordance with BS6946:1988. The brackets are designed and manufactured to primarily support and fix together Channel (Strut) lengths in a metal framework situation. All Channel (Strut) lengths are manufactured in accordance with BS6946:1988.

**Material:** Channel accessories and bracketry are predominantly made from Mild Steel material, in 6mm thick profile. Channel (Strut) lengths are manufactured from Pre Galvanised Steel to BS EN 10346: 2015 and are available in Standard gauge profile (2.5mm thickness) and also Light gauge profile (1.5mm thickness) and have either a Plain or Slotted option. (Slot sizes on Standard gauge are 28 x 14mm. Light gauge are 28 x 11mm).

**Finishes:** Channel Accessories and bracketry products are available with a Hot Dipped Galvanised finish. Channel (Strut) lengths are available in a Pre Galvanised finish. Both finishes are readily available from stock. Other finishes are available to order.

**Connections / Fixing Methods:** The range of Channel accessories and bracketry are predominantly pre drilled with 14mm fixing holes allowing the use of bolts and threaded rod to facilitate fixings.

**Country of Origin:** Channel accessories and bracketry are manufactured in India. Channel (Strut) lengths are manufactured in the UK.

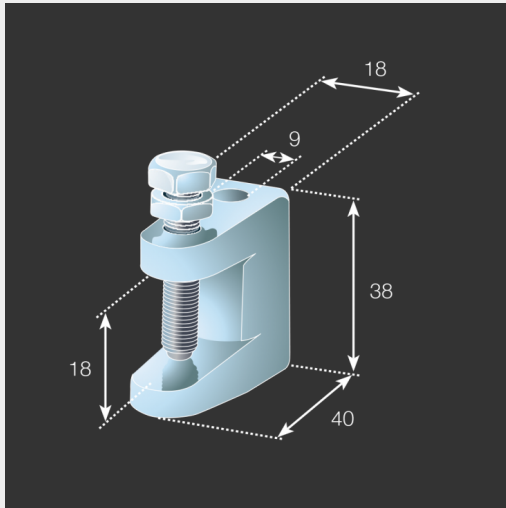

## BEAM CLAMPS BZP FM APPROVED - SIZE CHART

Size	Bag Qty	Pack Qty	Part No. - Fixings
M8	50	200	MZ0808/NA
M10	50		MZ1008
M12	50		MZ1208

## ABOUT THE PRODUCT

These are Greenaway's BEAM CLAMPS BZP, FM APPROVED . Greenaway FM approved beam clamps BZP or girder clamps are available in M8, M10 and M12 sizes. (A threaded clamp option is also available). Also known as flange clamps they are used to suspend or fix threaded rod and pipe clamps to an 'I' Beam, or 'H' beam (Rolled Steel Joist- RSJ or girder). They do not require drilling or welding and are designed for use throughout sprinkler systems, and other heating, ventilating and air - conditioning installations where steel structures allow. They are also FM and UL approved where stated and are made from cast iron with a bright zinc plated coating. The hexagon head screw supplied with cup point end is made of High Tensile steel (Grade 8.8) in a Bright Zinc Plated finish to help prevent sideways movement along the beam.

Every effort has been made to ensure the accuracy of data within these pages. We cannot however be held liable for any discrepancies that may arise between this data and actual product. The dimensions are provided as a guide and we recommend contacting a company representative for confirmation. Greenaway Pipeline Products Ltd reserve the right to make changes without notice at any time.

**Sales:** 01922 743 322

**Email:** [enquiries@greenaways.co.uk](mailto:enquiries@greenaways.co.uk)

**Web:** <https://greenaways.co.uk>